

**NOTES FOR INFORMATION:**  
 Borough/Parish Boundary - - - - -  
 Public Right of Way - - - - -  
**KEY:**  
 Land (Title) to be acquired  
 New Rights (Easement) to be acquired

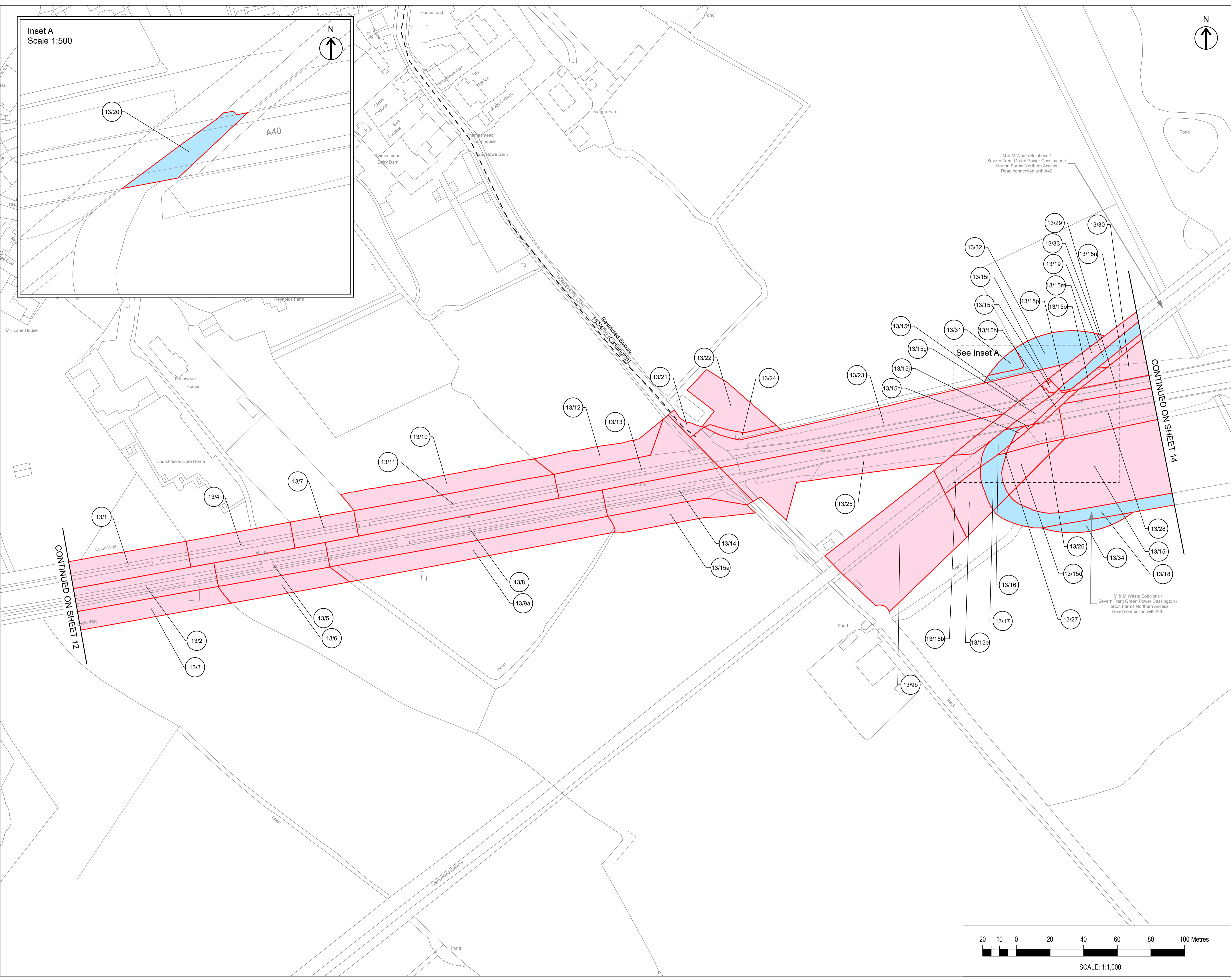

P02	Plots Updated	11/04/22	CG	SS	JH
P01	First Draft	10/01/22	LH	SS	JH
Rev	Description	Date	By	Check	Approved

This map is reproduced from Ordnance Survey material with the permission of Ordnance Survey on behalf of the Controller of Her Majesty's Stationery Office. © Crown Copyright. Unauthorised reproduction infringes Crown Copyright and may lead to prosecution or civil proceedings. Oxfordshire County Council, 0100023343, 2021



THE OXFORDSHIRE COUNTY COUNCIL  
 (HIGHWAYS INFRASTRUCTURE – A40  
 HIF2 SMART CORRIDOR  
 (HILL FARM TO DUKES CUT))  
 COMPULSORY PURCHASE ORDER 2022

COMPULSORY PURCHASE ORDER  
 SHEET 13 OF 19

A40 SMART CORRIDOR – EAST OF MARLBOROUGH  
 POOL TO EAST OF HORSEMERE LANE/RESTRICTED  
 BYWAY 152/4/10 (CASSINGTON)

The COMMON SEAL of  
 Oxfordshire County Council  
 was hereto affixed in the  
 presence of –

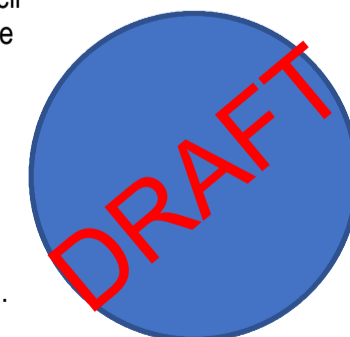

Authorised Officer  
 Dated this day of 202 Seal No. ....

Drawn	Checked	Approved	Date
CG	SS	JH	11/04/22

GH Project Number  
 132861.005 Scale at A1  
 1:1,000

Drawing Number  
 GH-132861005-CPO-13 Revision  
 P02

